

SPECIFICATIONS :
 Voltage Rating: 250V AC / DC
 Current Rating: 7A AC / DC
 Withstanding Voltage: 1500V AC/minute
 Temperature Range: -25°C~+85°C
 Insulation Resistance: 1000MΩ Min.
 Contact Resistance: 20mΩ Max.
 *Suitable C4201 series Male Terminal

*Material:
 Material: PA66 UL 94V-2/V-0
 Color:White

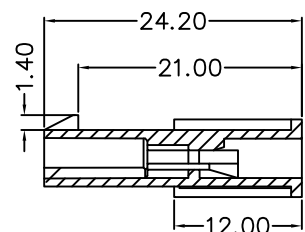
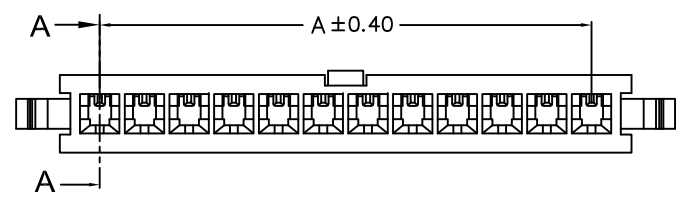

SECTION A-A

C4201HF X -NP-XX-XX
 ① ② ③ ④ ⑤ ⑥

- ① Series No.
- ② HF : Female Housing
- ③ 0: UL 94V-0
2: UL 94V-2
- ④ No. of Circuits
- ⑤ HF : Halogen Free
Blank: Rohs
- ⑥ NK: No Mark
Blank: Mark

Poles	Dimensions(mm)	
	DIM. A	DIM. B
02	4.20	9.70
03	8.40	13.90
04	12.60	18.10
05	16.80	22.30
06	21.00	26.50
07	25.20	30.70
08	29.40	34.90
09	33.60	39.10
10	37.80	43.30
11	42.00	47.50
12	46.20	51.70

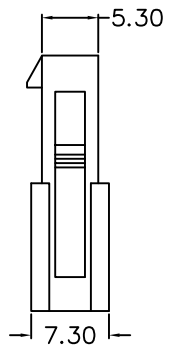
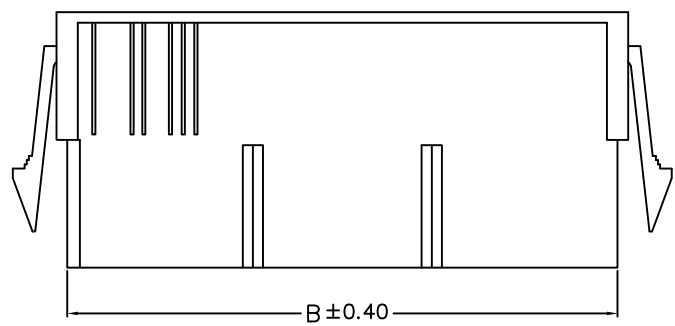

				GENERAL TOLERANCE	UNIT: mm	DATE	TITLE:			东莞市宏欣蓝电子有限公司			
				.X ± 0.30	X° ± 1°	DRAWN: 张自豪	MX4.2 母 Housing						
				.XX ± 0.20	.X° ±	CHECKED:	VER.	SCALE:	N/A	PROJECT	PART NO.	C4201HF-X-NP-XX-XX	
LTR	NAME	DATE	VERSION RECORD	.XXX ± 0.10	.XX° ±	APPROVED:	A0	SHEET:	1/1	DRAWING NO.		C4201HF	

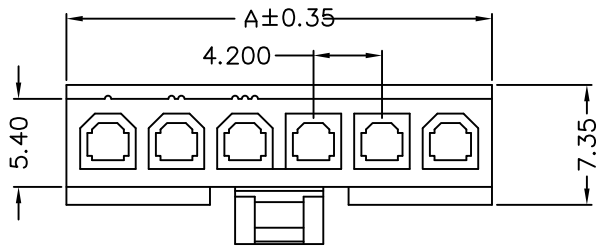

C4201HM 0-NP-XX-XX

① ② ③ ④ ⑤ ⑥

- ① Series No.
- ② HM : Male Housing
- ③ 0: UL 94V-0
2: UL 94V-2
- ④ No. of Circuits
- ⑤ HF : Halogen Free
Blank: Rohs
- ⑥ NK: No Mark
Blank: Mark

■ SPECIFICATIONS :

- Voltage Rating: 250V AC / DC
- Current Rating: 7A AC / DC
- Withstanding Voltage: 1500V AC/minute
- Temperature Range: -25°C~+85°C
- Insulation Resistance: 1000MΩ Min.
- Contact Resistance: 20mΩ Max.
- *Suitable C4201 series Female Terminal

*Material:

Material: PA66 UL 94V-2/V-0
Color:White

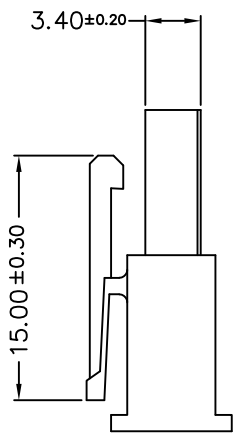
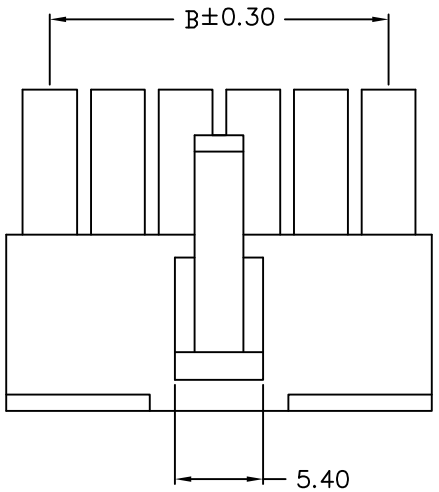
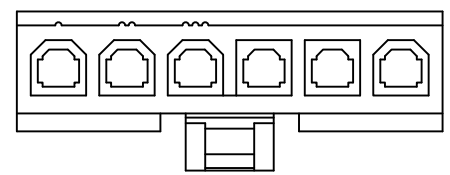
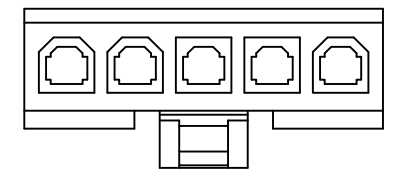
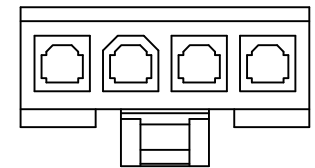
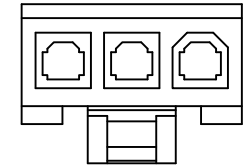
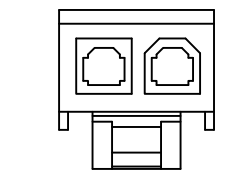

Poles	Dimensions(mm)	
	DIM. A	DIM. B
02	9.50	4.20
03	13.70	8.40
04	17.90	12.60
05	22.10	16.80
06	26.30	21.00

				GENERAL TOLERANCE		UNIT: mm		DATE		TITLE:			东莞市宏欣蓝电子有限公司			
				.X±0.30 X°±1°		DRAWN: 张自豪		2016.02.19		MX4.2 公 Housing						
				.XX±0.20 .X°±		CHECKED:				VER.	SCALE:	N/A	PROJECT	PART NO.	C4201HMX-NP-XX-XX	
LTR NAME DATE VERISION RECORD				.XXX±0.10 .XX°±		APPROVED:				A0	SHEET:	1/1	DRAWING NO.	C4201HM		

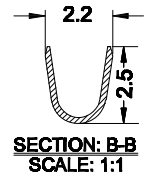
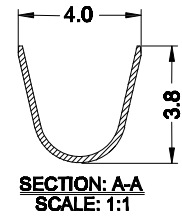
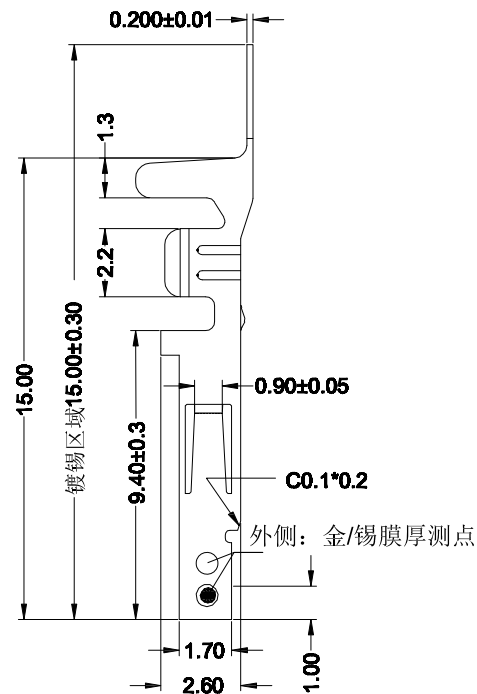
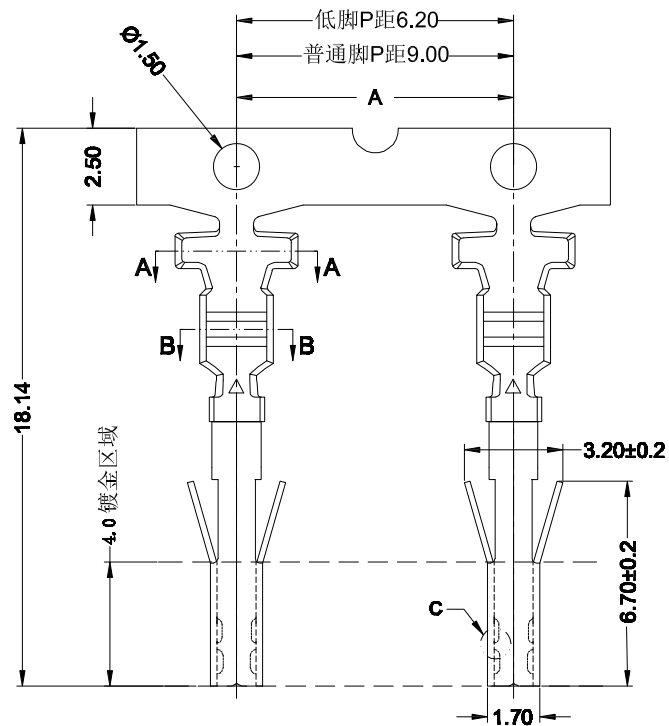

C4201TFX-XX-2-XX

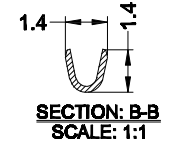
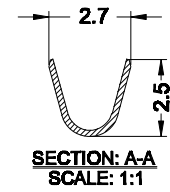

C4201TFX-XX-1-XX

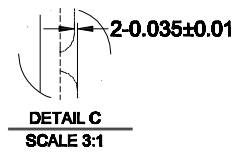
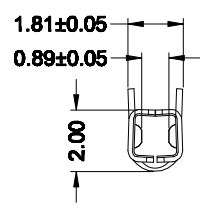

C4201 T F X-XX- X XX
① ②③④⑤ ⑥⑦

- ① Series No.
- ② T: Terminal
- ③ F: Female terminal
- ④ P: Phosphor Bronze
B: Brass
- ⑤ 2E: Tin-plated 先冲后镀
2: Tin-plated 先镀后冲
0A: 半金Gold Flash
- ⑥ 1: 低脚 2: 普通脚
- ⑦ NK: No Mark
Blank: Mark

Ordering Information & Specifications

Part No	Wire Range	Insulation O.D.	Material	Finish	DIM A(Pitch)
C4201TFX-2E-1-NK	AWG#22-#26	1.50mm(max)	Brass/Phosphor Bronze	Tin-plated	6.20mm
C4201TFX-2E-2-NK	AWG#16-#22	2.10mm(max)	Brass/Phosphor Bronze	Tin-plated	9.00mm

GENERAL TOLERANCE				UNIT: mm		DATE	TITLE:
.X ± 0.30	X° ± 1°	DRAWN:	张自豪	2016.09.04		MX4.2 母 Terminal	
.XX ± 0.20	.X° ±	CHECKED:					
.XXX ± 0.10	.XX° ±	APPROVED:					
LTR	NAME	DATE	VERSION RECORD				

东莞市宏欣蓝电子有限公司

PROJECT	PART NO.	C4201TFX-XX-X-XX
DRAWING NO.	C4201TF	

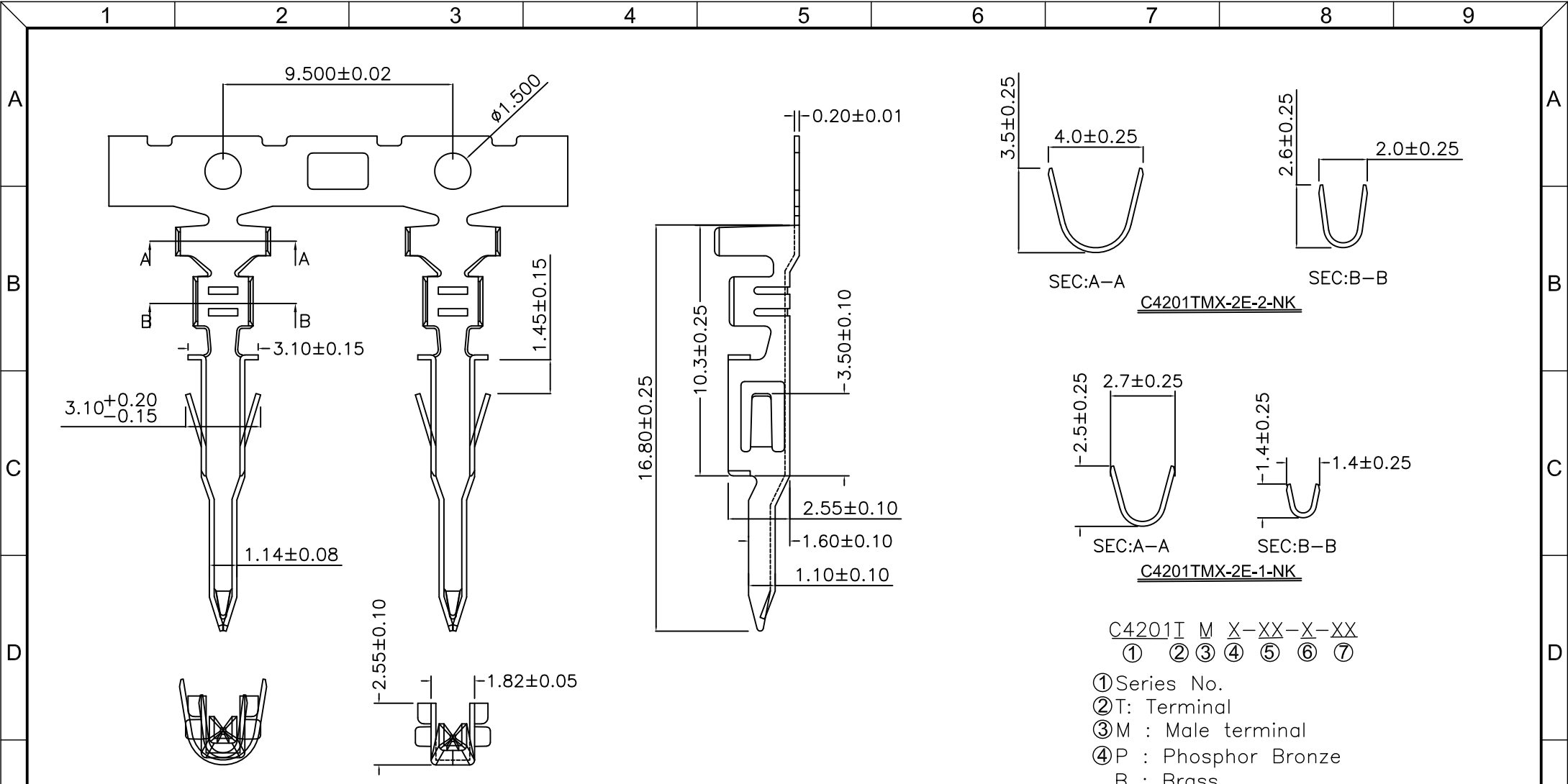

C4201I M X-XX-X-XX

① ② ③ ④ ⑤ ⑥ ⑦

- ① Series No.
- ② T: Terminal
- ③ M : Male terminal
- ④ P : Phosphor Bronze
B : Brass
- ⑤ 2E : Tin-plated 先冲后镀
0A : 半金Gold Flash
- ⑥ 1: 低脚 2: 普通脚
- ⑦ NK : No Mark
Blank : Mark

Ordering Information & Specifications

Part No	Wire Range	Insulation O.D.	Material	Finish	Qty/reel
C4201TMX-2E-1-NK	AWG#24-#28	1.40mm(max)	Brass/Phosphor Bronze	Tin-plated	5,000pcs
C4201TMX-2E-2-NK	AWG#16-#22	2.40mm(max)	Brass/Phosphor Bronze	Tin-plated	5,000pcs

				GENERAL TOLERANCE		UNIT: mm		DATE		TITLE:			
				.X±0.30 X°±1°		DRAWN: 张自豪		2016.09.04		MX4.2 公 Terminal			
				.XX±0.20 .X°±		CHECKED:				VER.	SCALE:	N/A	
LTR NAME DATE VERISION RECORD				.XXX±0.10 .XX°±		APPROVED:				A0	SHEET:	1/1	
							PROJECT			PART NO.		C4201TMX-XX-X-XX	
							DRAWING NO.			C4201TM			

东莞市宏欣蓝电子有限公司

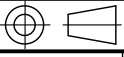

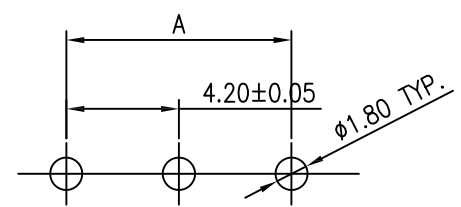
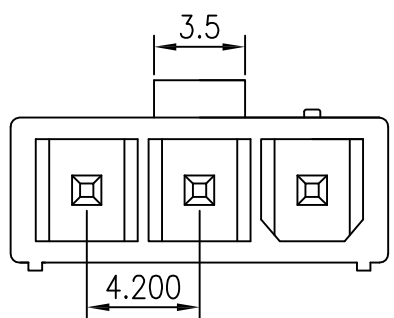

Recommended P.C.Board Layout

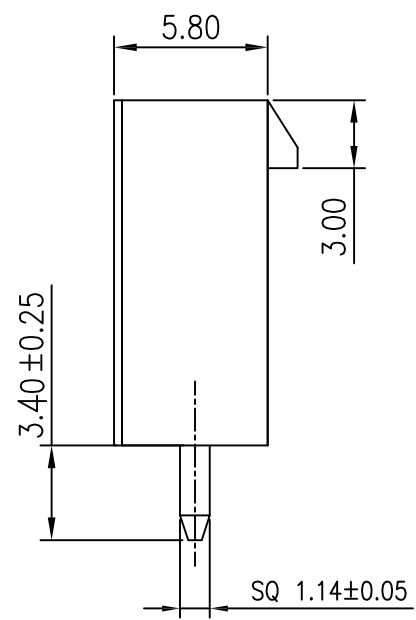
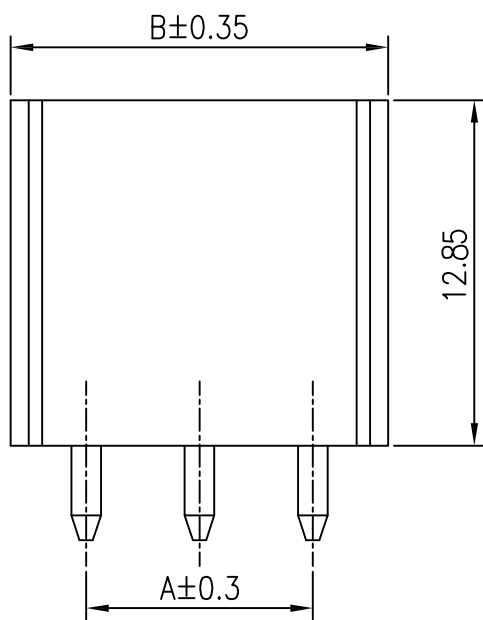

■ SPECIFICATIONS

- Voltage rating: 600V AC, DC
- Current rating: 7A, AC, DC
- Withstanding Voltage: 1500V AC/minute
- Insulation resistance: 1000MΩ min
- Temperature range: -25° C ~ +85° C
- Contact resistance: 20mΩ max

■ WAFER

- Part No. : C4202W00-NP-XX-XX
- Poles : 02-06P
- Housing Material: Nylon66 UL94V-2 or UL94V-0
- Pin Material: Brass
- Contact Area Plating: Tin-Plated or Gold-Flash
- Mates With: C4201 Single row receptacle
- The Dimension Marked "▼" Must Be Recorded

C4201W00-NP-XX XX

INSTULATOR / COLOR
 P2:PA66-V2 Natural
 B2:PA66-V2 Black
 P0:PA66-V0 Natural
 B0:PA66-V0 Black
 LP:LCP-V0 Natural
 LB:LCP-V0 Black
 9T:PA9T-V0 Natural
 9B:PA9T-V0 Black

CONTACT FINISH
 None: Tin-plated
 G: Gold-flash
 G3: 3u" Gold
 G10: 10u" Gold
 G15: 15u" Gold

PART NO.	Dimensions (mm)	
	A	B
02	4.20	9.80
03	8.40	14.00
04	12.60	18.20
05	16.80	22.40
06	21.00	26.60

				GENERAL TOLERANCE		UNIT: mm		DATE		TITLE:		
				.X ± 0.30	X° ± 1°	DRAWN: 张自豪		2016.04.18		MX4.20mm 单排 180° Wafer		
				.XX ± 0.20	.X° ±	CHECKED:				PROJECT		
				.XXX ± 0.10	.XX° ±	APPROVED:				PART NO. C4201W00-NP-XX-XX		
LTR	NAME	DATE	VERSION RECORD							DRAWING NO. C4201W00		
1	2	3	4	5	6	7	8	9				

东莞市宏欣蓝电子有限公司

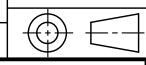

1 2 3 4 5 6 7 8 9

A

A

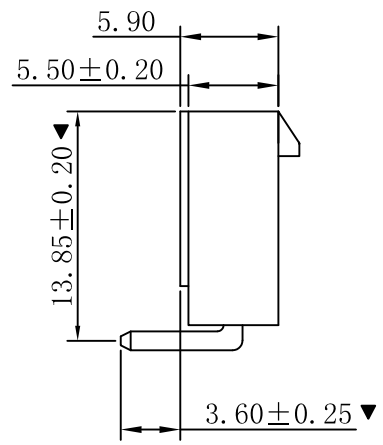
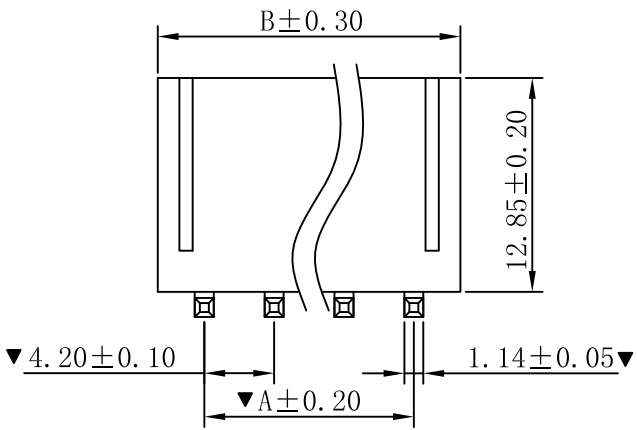

■ SPECIFICATIONS

- Voltage rating: 600V AC, DC
- Current rating: 7A, AC, DC
- Withstanding Voltage: 1500V AC/minute
- Insulation resistance: 1000MΩ min
- Temperature range: -25° C ~ +85° C
- Contact resistance: 20mΩ max

■ WAFER

- Part No. : C4202W90-NP-XX-XX
- Poles : 02-06P
- Housing Material: Nylon66 UL94V-2 or UL94V-0
- Pin Material: Brass
- Contact Area Plating: Tin-Plated or Gold-Flash
- Mates With: C4201 Single row receptacle
- The Dimension Marked "▼" Must Be Recorded

B

B

C

C

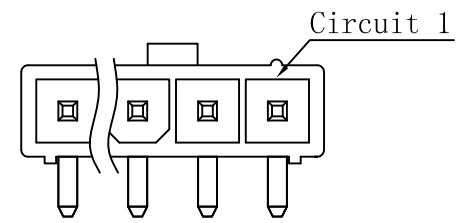

C4201W90-NP-XX XX

INSTULATOR / COLOR	CONTACT FINISH
P2:PA66-V2 Natural	None: Tin-plated
B2:PA66-V2 Black	G: Gold-flash
P0:PA66-V0 Natural	G3: 3u" Gold
B0:PA66-V0 Black	G10: 10u" Gold
LP:LCP-V0 Natural	G15: 15u" Gold
LB:LCP-V0 Black	
9T:PA9T-V0 Natural	
9B:PA9T-V0 Black	

D

D

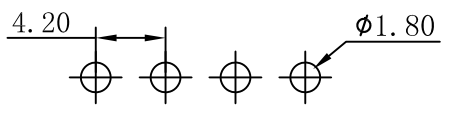
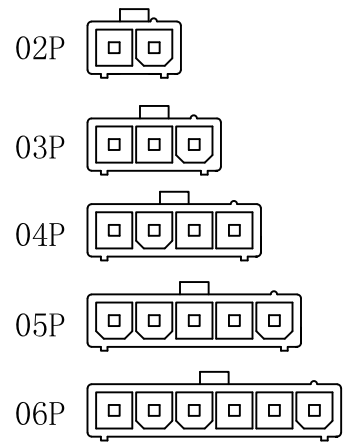
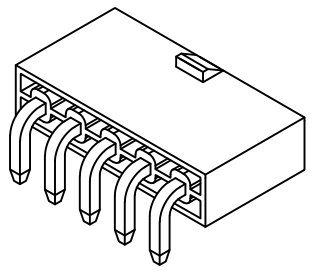

P. C. B LAYOUT

CIRCUIT SIZE LAYOUT

PART NO.	Dimensions (mm)	
	A	B
02	4.20	9.80
03	8.40	14.00
04	12.60	18.20
05	16.80	22.40
06	21.00	26.60

F

F

				GENERAL TOLERANCE		UNIT: mm		DATE		TITLE:	
				.X ± 0.30	X° ± 1°	DRAWN: 张自豪		2016.04.18		MX4.20mm 单排 90° Wafer	
				.XX ± 0.20	.X° ±	CHECKED:				VER. SCALE: N/A	
				.XXX ± 0.10	.XX° ±	APPROVED:				A0 SHEET: 1/1	
LTR	NAME	DATE	VERSION RECORD							DRAWING NO. C4201W90	

东莞市宏欣蓝电子有限公司

PROJECT PART NO. C4201W90-NP-XX-XX

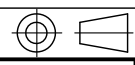

1 2 3 4 5 6 7 8 9